



PS4400

4400PSI 15.1L/MIN PETROL WATERBLASTER

4400PSI



INSTRUCTION MANUAL

CONTENTS

Introduction.....	3
Unpacking & Inspection.....	5
Safety.....	5
Components.....	11
Assembly / Attachments.....	12
Preparation.....	14
Starting.....	16
Operation.....	17
Maintenance.....	19
Storage.....	21
Troubleshooting Guide.....	23
General Info.....	26
Specifications.....	27
Warranty.....	28

CONGRATULATIONS!

Thank you for choosing this pressure washer. Our aim is to provide you with quality professional products and we want you to be totally satisfied with your product and our Customer Service. If any help or advice is needed, please contact us. When properly cared for this product will give you many years of satisfaction.

INTRODUCTON

This instruction manual is intended for your benefit. Please read and follow the safety, Installation, maintenance and troubleshooting steps described within to ensure your safety and satisfaction. The contents of this instruction manual are based upon the latest product information available at the time of publication. The manufacturer reserves the right to make product changes any time without notice.

GENERAL SAFETY

WARNING



Read and follow all Instructions. Failure to follow all instructions in this manual may result in severe personal injury or death. Keep this manual and refer to it for safety Instructions, Operating Procedures and Warranty.

SAVE THESE INSTRUCTIONS FOR FUTURE REFERENCE.

RECOGNIZE SAFETY SYMBOLS, WORDS AND LABELS

The safety instructions provided in this manual are not intended to cover all possible conditions and practices that may occur when operating, maintaining and cleaning power tools.

Always use common sense and pay particular attention to all the **DANGER, WARNING, CAUTION AND NOTE** statements in this manual.



This is the safety alert symbol. It is used to alert you to potential personal injury hazards. Obey all safety messages that follow this symbol to avoid possible injury or death.

DANGER

DANGER indicates an imminently hazardous situation which if not avoided will result in death or serious injury.

WARNING

WARNING indicates a potentially hazardous situation which if not avoided could result in death or serious injury.

CAUTION

CAUTION indicates a potentially hazardous situation which if not avoided may result in minor or moderate injury.

CAUTION

CAUTION used without the safety alert symbol indicates a potentially hazardous situation which if not avoided may result in property damage.

NOTE

NOTE provides additional information that is useful for proper use and maintenance of this tool. If a NOTE is indicated make sure it is fully understood.

In addition to **SAFETY ALERTS** listed above there could also be numerous symbols alerting the operator that specific safety measures are required to safely operate this tool. Learn these **SAFETY SYMBOLS** as well as the **SAFETY ALERTS** to prevent injury to the operator and to bystanders.



RAED OPERATING INSTRUCTIONS: Read and understand tool labels, safety warnings and precautions in this manual before operating the tool. Failure to follow WARNINGS could result in serious injury or even death to the operator or bystanders.



FIRE HAZARD: Heat from engine exhaust can ignite combustible materials, building structures or gas tanks resulting in a fire. Place the tool on a flat surface a safe distance from buildings or other combustible material. Ensure exhaust is directed away from tool.



WEAR APPROVED EYE PROTECTION: This tool has rotating and moving parts that could become airborne if damaged. Always wear approved eye protection when operating equipment with moving parts. Safety glasses must conform to the requirements of American National Standards Institute (ANSI) Z87.1 and provide protection against flying particles from both front and side.



POISONOUS: This tool has uses a gasoline powered engine that produces poisonous fumes from its exhaust. Always make sure there is adequate ventilation when operating this equipment.



EXPLOSION HAZARD: Fuel and its vapors are extremely flammable and explosive. Fire or explosion from these vapors can cause severe burns or even death.



ROTATING PARTS: Starter and other rotating parts on this tool can entangle loose clothing, long hair and accessories resulting in moderate to severe injury.



HOT SURFACES: Engine muffler and other engine parts can become very hot. Coming in contact with hot engine components can cause serious burns. Hot exhaust gases from the engine can cause clothing to ignite if in contact for any length of time.



KICKBACK: Starter cord can kickback (recoil) very rapidly. Kickback will recoil starter cord quicker than you can let go. This action can result in broken bones, bruises, sprains or fractures.



UNIT IS HEAVY: Take care when lifting or moving unit.



INJECTION HAZARD: Pressure washers can produce fluid streams severe enough to penetrate animal and human flesh.



SLIPPING AND FALLING: Pressure washer produce puddles of slippery liquid that can result in falls. Kickback from spray wand can result in falls when using unstable platforms.

IMPORTANT INFORMATION ABOUT THIS MANUAL

WARNING

Improper and unsafe use of this pressure washer can result in death, fire and/or bodily injury. This instruction manual contains important information about product safety. Keep the instruction manual available for others to read before they use the pressure washer

Improper maintenance and operation are responsible for the majority of accidents involving gas pressure washers. The largest portion of these could be prevented by recognizing the basic safety rules and precautions. Most accidents can be avoided if the operator recognized a potentially hazardous situation before it happens and by observing appropriate safety rules and procedures as outlined in this manual.

Basic safety precautions are outlined in the **SAFETY** portion of this manual and throughout the text in this manual where a potential might occur.

Hazards that **MUST** be avoided to prevent serious injury follow headers marked **DANGER** or **WARNING**. These same precautions are placed as labels on the tool itself.

NEVER use this pressure washer for applications that are **NOT** specified in this manual.

UNPACKING & INSPECTION

After opening the carton, unpack your new pressure washer and related parts & accessories. Please inspect it carefully for any damage that may have occurred during transit. If any parts are missing, please contact us on 0800 387 678

WARNING

Do not operate this pressure washer if damaged during shipment, handling or misuse. Damage may result in bursting, which can cause serious injury or property damage. All damaged parts must be repaired or replaced as needed prior to operating this pressure washer.

Check to see that all nuts, bolts and fittings are secure before putting this pressure washer into service. If you have any questions or require assistance with damaged or missing parts, please contact us on 0800 387 678

Please have the serial number, model number, date of purchase and parts list (with missing parts identified) available for reference when calling.

MODEL NUMBER:

SERIAL NUMBER:

DATE OF PURCHASE:

SAFETY WARNINGS

READ ALL SAFETY WARNINGS BEFORE USING PRESSURE WASHER.

GENERAL SAFETY RULES

WARNING

People with electronic devices, such as pacemakers, should consult their physician(s) before using this product. Operation of electrical equipment or the electromagnetic wave created by the engine spark plug in close proximity to a heart pacemaker could cause interference or failure of the pacemaker.

WARNING: This product contains chemicals known to the State of California to cause cancer and birth defects or other reproductive harm.

WARNING: The Engine Exhaust from this product contains chemicals known to the State of California to cause cancer, birth defects or other reproductive harm.

WARNING

Keep work area clean and well lit : Messy areas and cluttered workbenches invite PERSONAL injury and/or property damage. Clear all work areas of unnecessary tools, debris, furniture, etc.

Make sure the work area is well ventilated: Never operate in an enclosed area.

Do not place objects on top or against the tool.

Handle correctly. Always operate according to the instructions provided: Never allow the tool to be operated by children, individuals unfamiliar with its operation or unauthorized personnel.

Keep children and visitors away. All children should be kept away from the work area, **DO NOT** let children handle the tool. Maintain a safe distance for any person near the work area.

Childproof the workshop. The use of master switches and padlocks is highly recommended. Remove starter keys where applicable.

⚠ WARNING

Stay alert, watch what you are doing, and use common sense. Do not stand on the tools. Do not use tools while tired or under the influence of drugs, alcohol or medication. A moment of inattention while operating the tool may result in serious personal injury.

Operating any tools or equipment under the influence of drugs, alcohol, or medication can cause personal injury to yourself and others.

Use the right tool. Use tools properly and for their intended task. Do not force a small tool to do the job of a heavy-duty tool. Using the right tool to do the right job will make doing the job safer.

Always make sure the tool is in the OFF position when making adjustments, changing parts, or performing any maintenance.

Service must be performed only by qualified repair personnel. Service or maintenance by unqualified personnel may result in a risk of injury.

Do not use the tool if the power switch does not turn "ON" or "OFF". A tool that cannot be controlled with the switch is dangerous and must be repaired.

Store all maintenance tools away from the immediate area before turning ON the tool.

Do not overreach. Proper footing and balance is a must at all times while using tools. Unstable support may lead to personal injury. Do not stand on the tool. Serious injury could result if the tool tips over or you accidentally contact the tool.

When using accessories, consult the owner's manual provided by the manufacturer. The use of improper accessories may cause risk of injury to yourself and others.

Keep protective guards in place and in proper working condition.

Maintain tools and equipment with care. They will function better and more safely when kept clean and in good working condition. Keeping the tool clean, dry, and free of grime will add to its life and performance.

Do not use the tool for applications other than specified.

SAFETY RULES FOR GASOLINE ENGINES

⚠ WARNING



Carbon monoxide is a product of incomplete combustion, such as exhaust from the engine. Carbon monoxide is colorless, odorless and tasteless and can kill in a matter of minutes.

Carbon monoxide is a product of incomplete combustion, such as exhaust from the engine. Carbon monoxide is colorless odorless and tasteless and can kill in a matter of minutes.

Gas particulate filters and respirators will not protect someone from carbon monoxide poisoning. If symptoms of carbon monoxide poisoning appear, take the affected person outdoors immediately away from all structures and equipment that could produce the gas. Call for emergency medical treatment and make them aware of the situation.

Operate pressure washer only outdoors. Do not allow exhaust gas fumes from entering confined areas through windows, open doors, ventilation ducts and other openings.

Do not start or run engine indoors or an enclosed area, such as a garage (even if windows and doors are open).

This also applies to the engine compartment of a recreational vehicle(RV).

Then engine exhaust from this product contains chemicals known to the State of California to cause cancer, birth defects or other reproductive harm.

NOTE

Install a battery powered Carbon Monoxide (CO) detector near all bedrooms to alert occupants of dangerous levels of carbon monoxide. Carbon monoxide is a colorless, odorless, very poisonous gas.

The Emission Control System for engine is warranted for standards set forth by the EPA/Environmental Protection Agency and CARB/California Air Resources Board

SYMPTOMS OF CARBON MONOXIDE POISONING

Carbon monoxide (CO) is a colorless, odorless, tasteless, extremely toxic gas that can **KILL** in a matter of minutes. Breathing air containing carbon monoxide produces symptoms of headache, dizziness, loss of muscular control, a sleepy feeling and finally coma. Moderate or severe brain damage can result from inhaling air containing carbon monoxide. Carbon monoxide is a product of incomplete combustion of fuels and occurs in exhaust fumes of fuel-burning heaters and all internal combustion engines. Carbon Monoxide collects in spaces where there is no constant air flow or ventilation. **If you start to feel sick, dizzy or weak due to exposure to CO while using gasoline engine, GET TO FRESH AIR IMMEDIATELY.**

ADDING OR DRAINING FUEL TO OR FROM THE ENGINE

⚠ WARNING



Fuel and fuel vapors are extremely flammable and explosive. Fire and explosion can result in severe burns and even death.

- Turn engine to the **OFF** position and let cool at least two minutes before removing fuel cap. Loosen cap slowly to relieve pressure in fuel tank.
- **DO NOT** fill or drain fuel tank inside enclosed structures. Accidental sparks can result in fires or explosions leading to severe burns and even death.
- **DO NOT** overfill fuel tank. Leave ample space for expansion of fuel.
- **DO NOT** start engine in area of fuel spillage. Fire and explosion can occur.
- Keep fuel away from sparks, open flames, pilot lights, heat and other ignition sources. **DO NOT** smoke while operating the engine.
- **DO NOT** tip engine or equipment at angle that could result in fuel spilling from fuel tank.

STARTING THE ENGINE

⚠ WARNING



Starter cord kickback (rapid retraction) can pull your hand and arm toward the engine faster than it can be let go of. Failure to be aware of this function can result in broken bones, fractures, bruises and sprains can result.

- When starting the engine, pull cord slowly until resistance is felt, then pull rapidly to avoid kickback.

WARNING



Unintentional sparking can result in fire or electric shock. Failure to observe this warning can result in property damage, severe burns and/or death.

- Ensure spark plug is in place before attempting to start engine.
- Ensure muffler is secured to engine before starting.
- Ensure fuel cap is on fuel tank and tightened securely.
- Ensure air cleaner is clean and properly attached to engine.



A dirty air cleaner element changes the air to fuel ratio and promotes incomplete combustion of fuel increasing the output of carbon monoxide. Always make sure air cleaner element is clean before every operation of the engine.

- **DO NOT** crank engine with spark plug wire removed. The resulting spark could ignite spilled fuel.

⚠ WARNING



Do not contact the muffler area with engine running. The muffler gets extremely hot and can cause severe burns. Exhaust gases can ignite combustible items such as clothing or structures in close proximity. Gases leaking from a worn muffler can heat up and damage the fuel tank resulting in fire or explosion.

- **DO NOT** touch hot parts of engine or muffler.
- **AVOID** hot exhaust gases.
- Keep a minimum of 5 ft. (1.5M) clearance on all sides of the engine including top.

⚠ WARNING



Starter and other rotating parts of engine can entangle hair, hands, clothing and accessories.

- **NEVER** operate with protective housing or covers removed.
- **DO NOT** use while wearing loose clothing or jewelry that may get caught up in the starter or other rotating parts. Tie up long hair or wear a hair net or cap.

MAKING ADJUSTMENTS OR REPAIRS TO THE ENGINE

⚠ WARNING

Excessively high operating speeds increases risk of injury and damage to the engine. Excessively low speeds produce heavy load on the engine.

- **DO NOT** attempt to alter pre-set governed speed. Engine governor is factory set to supply optimum output horse power(HP) when running at the governed speed.
- **DO NOT** modify the engine in any way.

TESTING SPARK PLUG FOR SPARK

⚠ WARNING

- **DO NOT** check spark plug for spark by removing from head cylinder.
- Disconnect spark plug wire from spark plug and cover tip with non-conducting material such as electrical tape to prevent it from coming in contact with spark plug, fuel tank or other parts of the engine where damage can result from sparking.
- Replace a defective spark plug only with authorized parts.
- Use an approved spark plug tester.

TRANSPORTING OR REPAIRING EQUIPMENT

⚠ WARNING

RISK OF PROPERTY DAMAGE WHEN TRANSPORTING PRESSURE WASHER: Turn off the pressure washer before transport. Use caution when moving the pressure washer. Oil can leak or spill and could result in a fire or breathing hazard serious injury or death. Oil leaks will damage carpet, paint, or other surfaces in vehicles or trailers. Be sure to use the handle to lift or carry the pressure washer.

⚠ CAUTION



- The wheel kit is not designed for over-the-road use. Pressure washer must be transported in a vehicle or on a trailer.
- **Unit is heavy.** Take care when lifting or moving unit.
- Transport or repair with fuel tank **EMPTY** to prevent an unintentional spark igniting fuel vapors resulting in a fire or an explosion.
- Transport or repair with the spark plug wire **DISCONNECTED**.

STORING FUEL OR EQUIPMENT WITH FUEL IN FUEL TANK

⚠ WARNING

Store away from furnaces, stoves, water heaters, clothes dryers, and all other appliances with pilot lights or other ignition sources. These appliances can heat fuel tanks and ignition sources can ignite fuel vapors.

SAFETY RULES FOR PRESSURE WASHERS

⚠ DANGER

RISK OF FIRE OR EXPLOSION



Always store fuel away from the pressure washer and in an approved container. Fuel and fuel vapors are extremely flammable and explosive. Fire and explosion can result in severe burns and even death.

Make sure all ventilation openings are clear and free from restrictions. Restricted ventilation openings can cause overheating and/or fire.

⚠ WARNING



Do not operate the pressure washer in explosive areas, such as in the presence of flammable liquids, gases or dust. Pressure washers can create sparks which may ignite the dust or fumes. **Never use the Pressure washer in damp or wet locations.**

Wear proper apparel. Remove your jewelry before using pressure washer. Do not wear loose clothing, necklaces, rings, bracelets, or other jewelry, which may get caught in moving parts. Nonskid footwear and electrically non-conductive gloves are highly suggested while working. Wear protective hair covering to contain long hair.

Be responsible for your hearing. Wear hearing protection during extended periods of operation.

Do not use the pressure washer if excessive noise or vibration is present. Have it repaired immediately.



Store the pressure washer indoors, in a dry, secured area away from other equipment. Never store the pressure washer near an open flame or flammable materials. Keep pressure washer a minimum of 5 feet (1.5 m) of clearance on all sides including overhead.

⚠ WARNING

RISK OF INJURY



Pressure washer produces fluid pressures and velocities high enough to penetrate human and animal flesh which could result in serious injury or amputation.

Ensure all connections are tightened securely. Inspect all hoses to ensure they are not damaged or kinked. Loose connections or damaged hoses can result in injection injuries.

NEVER place hands in front of nozzle.

NEVER attempt to attach or remove spray wand or hose fittings while pressure washer system is pressurized.

DO NOT treat fluid injection injuries as a simple cut. See immediate medical attention.

DO NOT allow pressure hose to come in contact with engine muffler.

HIGH VELOCITY fluid spray can cause objects to break, propelling particles at high speeds.

ALWAYS wear approved safety glasses when using or doing maintenance on pressure washers.



NEVER substitute safety glasses for **GOGGLES**. Injury to eyes could occur.

ALWAYS wear protective clothing to prevent accidental spraying.

DO NOT permanently secure spray wand trigger in open position.

DO NOT use spray wand that does not have a trigger lock or trigger guard in place and in proper working order.

⚠ WARNING

DO NOT use acids, toxic or corrosive chemicals, poisons, insecticides, flammable solvents or bleach with pressure washer. Use of these chemicals can result in damage to equipment or serious injury or death.



DO NOT direct spray toward electrical outlets, switches or products connected to electrical service. Failure to observe this warning can result in electrocution resulting in severe electrical shock or burns and possibly resulting in death.

NEVER run pressure pump without the water supply connected and turned on. Non-repairable damage to the pump will occur.



RISK OF FALLING

Pressure washer can create puddles of slippery solutions that can become hazardous.

Ensure you stand on a stable surface while operating pressure washer. Initial kickback from engaging spray wand can cause you to lose your balance and fall resulting in minor to severe injuries.

Use extreme caution if you must operate washer from a ladder or scaffolding. Kickback from spray wand can result in loss of balance and result in a fall that could cause serious injuries.

When cleaning pressure washer, ensure there are adequate slopes for drainage so solutions don't create puddles around unit that could result in slipping and falling.

Firmly hold spray wand with both hands when using high pressure spray avoiding injury should spray wand kick back.

⚠ CAUTION

The pressure washer must be run with the rubber feet resting on a flat and stable horizontal surface.

The pressure washer must be used in a clean and well-ventilated area. Keep pressure washer a minimum of 5 feet (1.5m) of clearance on all sides including overhead.

DO NOT place pressure washer in an area:

- **Where** there is evidence of oil or gas leaks.
- **Where** flammable gas vapors or materials may be present.
- **Where** extremely dirty air or water could be drawn into the pressure washer.

COMPONENTS

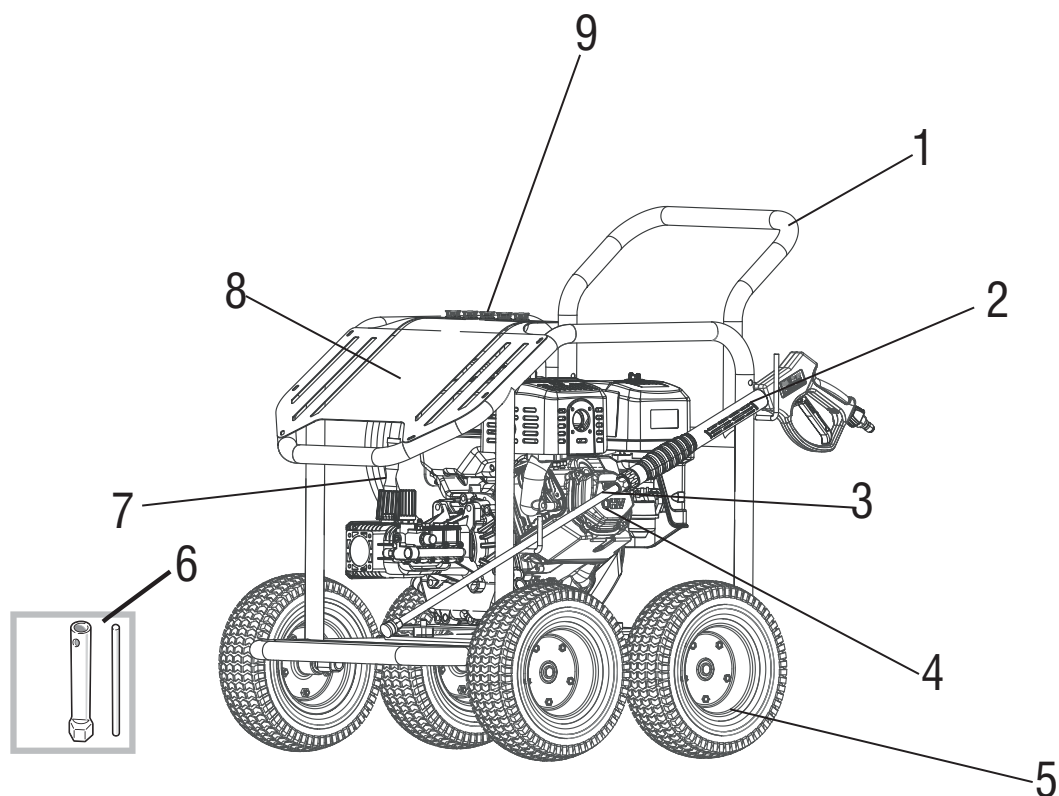

PRESSURE WASHER FEATURES:

- | | |
|--------------------|---------------------------|
| 1. Frame | 6. Tool Kit |
| 2. Spray Gun | 7. High Pressure Hose |
| 3. Spray Wand | 8. Nozzle Panel |
| 4. Gasoline Engine | 9. Nozzle Cleaning Needle |
| 5. Wheel Kit | |

PRESSURE WASHER TERMINOLOGY

Following are common terms associated with the use of pressure washers:

PSI: Pounds per square inch-common unit measure used for water pressure, air pressure, hydraulic pressure and pounds of force.

L/min: Litres per minute (liters per minute metric) - common unit measure used for flow rate of water.

Bypass Mode: In bypass mode, high pressure pump recirculates water because spray gun trigger is not squeezed.

Thermal Relief Valve: When in Bypass Mode, this valve releases a jet of water to prevent water temperatures from reaching harmful levels that damage the pump. Once the water has cooled, the thermal relief valve reset itself. Do not allow pump to run without spraying (in Bypass Mode) for more than 5 minutes.

ASSEMBLY/ ATTACHMENTS

This pressure washer requires some assembly and will be ready for use after servicing with manufacturer approved oil and fuel. If you have any problems with the assembly of your pressure washer, please call 0800 387 678. If calling for assistance, please have the model, revision, and serial number from the data tag available.

PRESSURE WASHER

⚠ WARNING



Unit is heavy: Do not attempt to lift and remove the pressure washer unit from the carton.

1. Using a box cutter, open carton completely by cutting the four corners allowing the sides to lay flat. Leave pressure washer on the carton.
2. Remove all items except the pressure washer from the box and inspect for completeness (See Functional Description).
3. Carefully tip the pressure washer forward and place on its front side and proceed to assemble the unit using the provided tools.
4. Insert the shaft through the holes in the bottom frame tubing as shown.
5. Assemble the wheels to the shaft (using the bushings, washers and cotter pins). To secure the Wheels to the shaft, insert the Cotter Pins inside the small holes in the shaft and bend back the end of the Cotter Pins using a pair of pliers (not provided).
6. After completion of wheel/leg assembly, carefully place the pressure washer on its wheels.
7. Pull the handle lock pin and fully raise the handle upright. Release and snap the lock pin into its lock-ing hole in the frame.
8. Assemble the top and bottom gun holders (using the nuts and bolts) to the frame as shown. Tighten all mounting hardware.

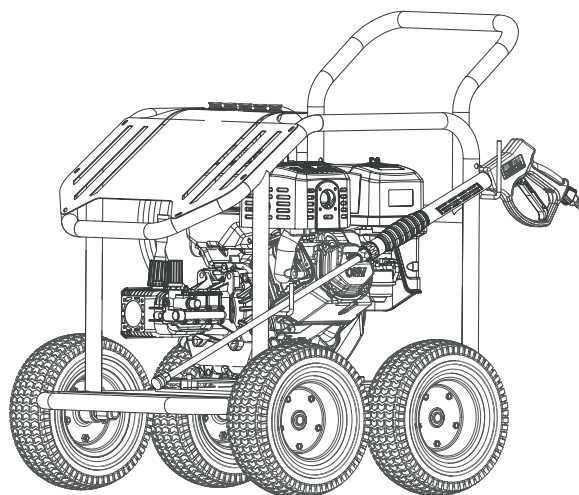

PRESSURE HOSE TO PRESSURE PUMP

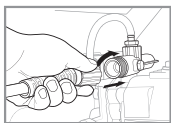

Pull back the high pressure outlet fitting collar. Insert Pressure Hose inside the fitting and release collar. Tug on the hose to make sure it is secured.

PRESSURE HOSE TO SPRAY GUN

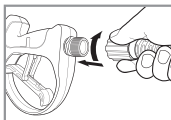

1. Pull slip ring on female quick-disconnect fitting of high pressure hose back.
2. Insert male quick-disconnect fitting on spray gun into female quick-disconnect on high pressure hose.
3. Release slip ring on female quick-disconnect and twist. Listen for "click" to ensure both quick-disconnects are coupled.
4. Pull high pressure hose and spray gun in opposite direction to ensure they do not separate.

SPRAY WAND TO SPRAY GUN

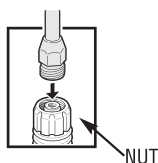

1. Remove the protective plastic cap at the inlet of the wand.
2. Thread spray wand onto spray gun.
3. Tighten the nut to secure the Wand to the Gun.

SELECTING THE RIGHT NOZZLE FOR THE JOB

NOTE

To prevent damage to your surface and to select an appropriate nozzle size for your application, always start with the lowest pressure nozzle size (White) and continue changing to the higher nozzle size until the best work result is achieved.

The pressure Washer comes furnished with five spray nozzles. Each nozzle is color coded and delivers a specific spray pattern and pressure for a particular cleaning job. The size of the nozzle determines the size of the fan spray and the pressure out of the nozzle.



0° Nozzle - Red: This nozzle delivers a pinpoint stream of pressurized water and is extremely powerful. It covers only a small area of cleaning. This nozzle should only be directed at surfaces that can withstand high pressure such as metal or concrete. Do not use this nozzle to clean wood.



15° Nozzle - Yellow: This nozzle delivers a powerful 15 degree spray pattern for intense cleaning of small areas. This nozzle should only be used on areas and materials that can withstand high pressure.



25° Nozzle - Green: This nozzle delivers a 25 degree spray pattern for intense cleaning of larger areas. This nozzle should only be used on areas that can withstand pressure from this nozzle.



40° Nozzle - White: This nozzle delivers a 40 degree spray pattern and a less powerful stream of water. This nozzle can cover a wide area and should be used for most general cleaning jobs.



Chemical Nozzle - Black: This nozzle is used to apply special chemicals and cleaning solutions. This nozzle produces the weakest pressure stream of the five nozzles.

The Pressure Washer nozzles are stored in receptacles on a panel mounted to the handle of the washer. Colors on the panel identify nozzle location and spray panel.

NOZZLES TO SPRAY WAND

⚠ WARNING

Never place hands in front of nozzle. Never grasp hose or fittings during Pressure Washer operation. Never attempt to attach or remove spray wand or hose fittings while Pressure Washer system is pressurized.

Turn off pressure Washer and lock the Gun trigger before attempting to change pressure nozzles.

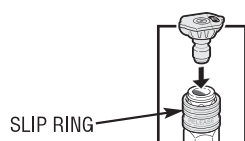

1. To attach, insert nozzle into female quick-disconnect spray wand and press to snap in the nozzle.
2. To detach, slide down slip ring on female quick-disconnect to eject the nozzle.

PRESSURE PUMP TO WATER SUPPLY

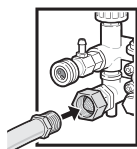

1. Connect the garden hose to the water supply and turn water supply on to fill the hose with water and also remove any debris in the hose. Turn OFF water supply.
2. Make sure that the filter inside the Pressure Washer water inlet is clean and undamaged. Thread the garden hose fitting into the water hose inlet. Hand tighten the inlet nut.
3. Turn on water supply.

⚠ NOTE

The Pressure Washer requires a minimum of 20 PSI and a flow rate of 18.9L/min.

PREPARING THE PRESSURE WASHER

⚠ WARNING

Improper treatment of pressure Washer can damage internal components and shorten the life of unit. Failure to follow this warning will void warranty.

PRESSURE PUMP

The Pressure Washer is shipped with shipping oil plug to prevent oil leakage from the pump during shipping. To replace the shipping plug with the Breather Plug (provided) perform the following:

⚠ WARNING

Failure to remove shipping plug and replace it with the dipstick/oil plug will damage pressure pump. Failure to add pump Breather Plug could void warranty.

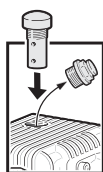

1. Using a wrench, remove shipping plug from pressure pump. Discard shipping plug.
2. Remove pump Breather Plug from parts bag and insert it into pressure pump.
3. Tighten pump Breather Plug securely by hand. Do not use wrench to tighten. Using a wrench to tighten pump Breather Plug could strip threads.
4. Use the level glass window on the side of the pump to ensure that pump oil is at the mid point or above.
5. Add oil to pressure pump if level is below the prescribed level. Use only SAE30 non-detergent oil.

ADDING ENGINE OIL

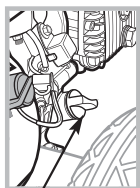

DIP STICK

1. Move the Pressure Washer **OUTSIDE** and place on a flat and level surface.
2. Remove the engine oil dip stick and place the funnel in the oil reservoir.
3. Pour the supplied engine oil (SAE30) until the oil level reaches the threads inside the oil reservoir.
4. Hand tighten oil dip stick and wipe off any spilled oil.

LOW OIL SENSOR

To prevent engine damage caused by an insufficient amount of oil in the crankcase, engine is equipped with a low oil sensor. If the oil is below the safe amount, the sensor will activate and will prevent engine start-up or will stop the running engine. If Pressure Washer shuts off and the oil level is within specifications, check to see if Pressure Washer is sitting at an angle that forces oil to shift.

Place on an even surface to correct this. If engine fails to start, the oil level may not be sufficient to deactivate low oil level sensor. Add oil as described above.

ADDING FUEL

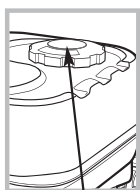

CAP

1. Move the Pressure Washer **OUTSIDE** and place on a flat and level surface.
2. Remove the gas tank cap. Carefully add 91 Octane (or higher) grade gasoline to the tank. DO NOT OVERFILL. Leave room for the gasoline to expand.
3. Replace and hand tighten gas cap and wipe off any spilled fuel.

⚠ WARNING



Fuel and fuel vapor are extremely flammable and explosive. Fire or explosion from misuse of fuel can cause severe burns and even death. Failure to use as recommended in this manual will void the warranty.

WHEN ADDING FUEL TO PRESSURE WASHER, OBSERVE THE FOLLOWING:

- **DO NOT** use unapproved gasoline such as E85(85% ethanol/15% gasoline).
- **DO NOT** mix oil with gasoline.
- **DO NOT** modify engine to run on alternate fuels.
- Turn Pressure Washer OFF and let it cool for at least two minutes before removing fuel cap. Loosen fuel cap slowly to release pressure.
- Keep fuel away from sparks, open flames, pilot lights, heat and other ignition sources.
- **DO NOT** light a cigaretter or smoke near open fuel tank or container.
- Clean area around fuel cap, slowly remove cap to allow any pressure to escape.
- Install fuel cap and allow any spilled fuel to evaporate before starting engine.
- DO NOT overfill fuel tank. Slowly add unleaded gasoline (A) to fuel tank (B). Use extreme caution not to fill fuel above the baffle (C). This allow appropriate space for fuel expansion.

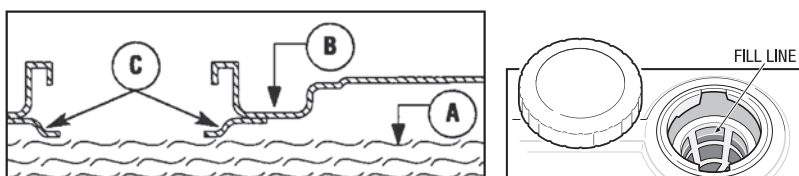

USING PRESSURE WASHER AT HIGH ALTITUDES

Engine Carburetor is factory adjusted for optimum operation from 0 to 1500 meters above the sea level. Approximately 10% of a power drop in the engine is expected with respect to each climb of 1000 meters in altitude. To maintain proper emissions compliance and optimum performance & fuel consumption, high altitude adjustment may be required for altitudes above 1500 meters. If adjustment is required call 0800 387 678

STARTING

PRIOR TO STARTING THE PRESSURE WASHER, MAKE SURE THAT YOU HAVE:

1. Selected a proper size nozzle for the job at hand (see “SELECTING THE RIGHT NOZZLE”).
2. Attached the Pressure Washer to the water source and turned on the source (see “ATTACHING THE PUMP TO WATER SUPPLY”).

⚠ WARNING

DO NOT run the pump without the water supply connected and turned on. Damage to the Pressure Washer resulting from failure to follow this instruction **WILL** void the warranty.

3. For your protection, wear protective safety glasses.
4. Move the Pressure Washer **OUTSIDE** in a fully **VENTILATED** area.
5. Place the Pressure Washer on a **FLAT** and level surface and close to the working surface. Keep a minimum of **5 ft.(1.5 meters) CLEARANCE** on all sides of the engine including the top. Face the engine exhaust outlet **AWAY** from dwellings.
6. Make sure the Throttle lever is set to the “FAST” position (left).
7. Slide the Fuel Valve lever to “**ON**” position (right) to allow the fuel to flow to the engine.
8. Slide the Choke lever to “**START**” position (left).
9. Turn the Engine **ON/OFF** switch clockwise to **ON** position.
10. Point nozzle to a safe direction and squeeze the Spray Gun trigger to allow for easier engine start.
11. To start the engine, pull Starter cord slowly until resistance is felt, then pull rapidly to avoid kick back. Repeat until engine starts to run. Release the trigger.
12. Slide Choke Lever to “**RUN**” (right) position.

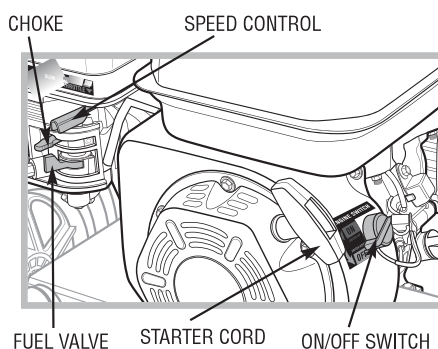

OPERATING

⚠ WARNING

Do not leave Pressure Washer in bypass mode for more than two minutes at a time. Water temperature inside the pressure pump will rise to a dangerous level resulting in damage to the internal components of the pump. Failure to follow this warning will void warranty. **DO NOT** run the pressure pump without the water supply connected and turned on. Damage to the Pressure Washer resulting from failure to follow this instruction **WILL** void the warranty.



ALWAYS wear approved safety glasses when operating Pressure Washers. Spray can splash back or propel objects, including incorrectly attached accessories.

⚠ WARNING



The high pressure stream of water that this equipment produces can cut through skin and its underlying tissues, leading to possible amputation.



Spray gun traps high water pressure, even when the motor is stopped and water is disconnected, which can cause injury. Kickback from spray gun can cause you to fall.

USING THE SPRAY GUN

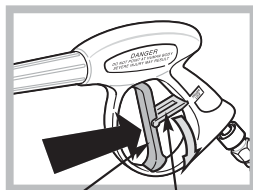

TRIGGER
TRIGGER LOCK

To engage the Trigger Lock, pull the lock up until it clicks into the slot.

To disengage the Trigger Lock, push the lock down and into its original position.

TO OPERATE THE TRIGGER:

1. Squeeze the trigger to start water flow through the nozzle.
2. Release the trigger to stop water flow.

WASHING/CLEANING

1. Firmly grip Spray Gun with both hands.
2. Point the nozzle to a safe direction and squeeze the Spray Gun trigger to allow the pump to purge air and impurities in the system and then redirect the nozzle to the working surface.
3. When finished, release the Gun Trigger to stop water flow.

USAGE TIPS:

- For most effective cleaning, Keep spray nozzle 8 to 24 inches away from the cleaning surface.
- If you get the spray nozzle too close, especially using high pressure mode, you may damage the surface being cleaned.
- **DO NOT** get closer than 6 inches when cleaning tires.

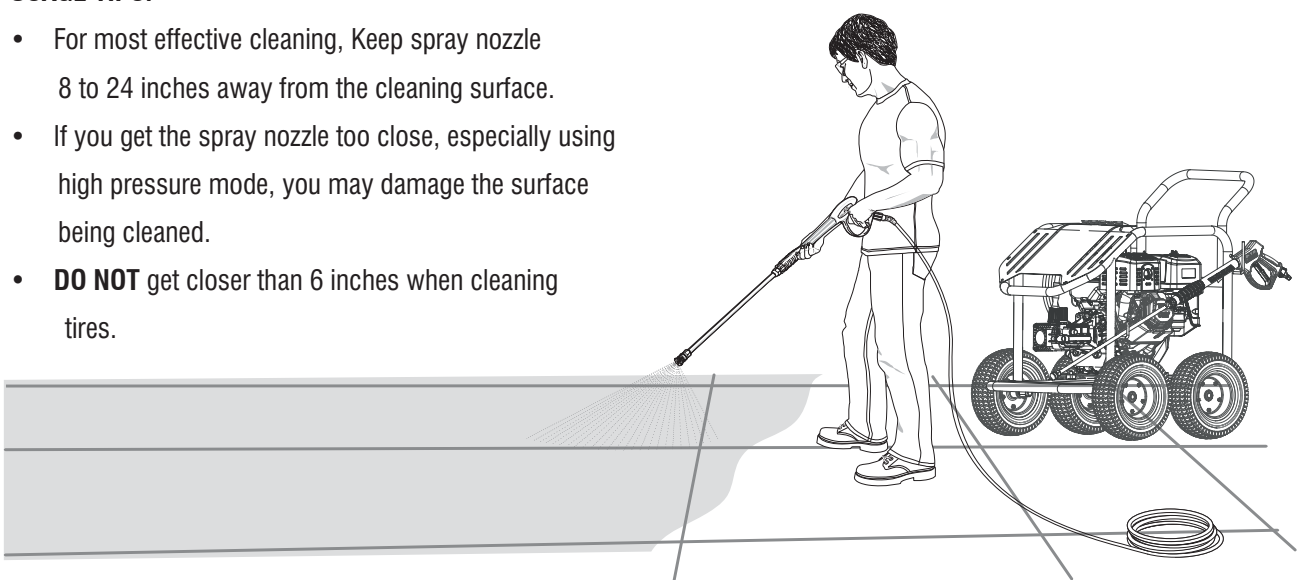

PRESSURE ADJUSTMENT

Increase distance: To vary the pressure on the surface being cleaned, vary the distance between the spray wand and the surface being cleaned.

Change pressure wand nozzle: Completely shut down Pressure Washer and stop gasoline engine. Change spray nozzle for desired pressure (see “SELECTING THE RIGHT NOZZLE”). Restart engine.

Adjust pump pressure regulator: The pump pressure regulator allows pressure adjustment at the pump. Turn pressure regulator knob on pressure pump counterclockwise/clockwise to decrease/increase pressure.

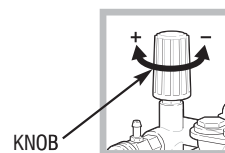

USING CHEMICALS AND CLEANING SOLVENTS

▲ NOTE

Use only soaps and chemicals designed for use with Pressure Washers. **DO NOT USE CHLORINE BLEACH.**

Chemicals, soaps and cleaning solvents will not siphon when a high pressure nozzle is used. Use the Chemical Nozzle (Black).

TO APPLY DETERGENT:

- 1.Prepare detergent solution as recommended by the manufacturer.
- 2.Remove the detergent tank lid located in front of the Pressure Washer.
- 3.Fill tank with prepared detergent solution. A small funnel may help with this task. Replace the detergent tank lid.
- 4.Lock the trigger and attach the Detergent Nozzle (Black) to the Wand.
- 5.Unlock the trigger and squeeze spray gun trigger and apply detergent to a dry surface, starting at the lower portion of area needing to be washed and work upward, using long, even, overlapping strokes.

▲ NOTE

Wetting the surface first is not recommended, as it dilutes the detergent and reduces its cleaning ability.

- 6.Allow detergent to “soak in” for 3-5 minutes before washing and rinsing. Reapply as needed to prevent surface from drying. Do Not allow detergent to dry on surface(prevents streaking).

TO RINSE:

- 1.Replace the nozzle with an appropriate high pressure nozzle (see“SELECTING THE RIGHT NOZZLE”). Squeeze the trigger and wait for the detergent to clear
- 2.Keep the spray gun a safe distance from the area you plan to spray.
- 3.Apply a high pressure spray to a small area,and then check the surface for damage. If no damage is found, it is okay to continue cleaning.
- 4.Start at the top of the area to be rinsed, working down with the same overlapping strokes as you used for washing and applying detergent.

TO FLUSH SYSTEM

When you have completed the use of detergent injection system:

- 1.Turn off the engine and fill the detergent tank with clean water.
- 2.Remove the nozzle and then turn engine back on.
- 3.Point the wand toward a safe direction and squeeze the trigger to flush clean water through the detergent tank and the system until it is thoroughly clean.

⚠ WARNING

Leaving chemicals and cleaning solutions inside the pressure pump could damage it. Damages created by leaving soaps, chemicals and cleaning solutions inside the pump can void the warranty.

CLEANING TIPS:

- Never use the Pressure Washer water inlet to siphon detergent or wax.
- If you have the nozzle too far away from the surface being washed, the cleaning will not be as effective.

IMPORTANT: DO NOT get closer than 6 inches when cleaning.

SHUTTING DOWN

1. To stop the engine, set the engine switch on the side of the engine to OFF position.
2. Slide Fuel Valve lever to the left to stop fuel flow to the engine.
3. Turn off the water supply and disconnect garden hose from the Pressure Washer.
4. Squeeze the Gun trigger to release any remaining water in the system.
5. Store Spray Gun on the side and hoses inside the hose housing inside the handle.
6. **CAUTION-Allow engine to cool down before folding the handle.**

⚠ CAUTION

Never turn off water supply with engine running. This will cause the pressure pump to overheat resulting in internal damage. Pressure Washer **MUST** be properly stored. Refer to next pages for proper storage instructions.

MAINTENANCE

Regular maintenance will improve performance and extend life of the Pressure Washer. The Pressure Washer's warranty does not cover items that have been subjected to operator abuse or negligence. Only by maintaining the Pressure Washer in accordance with instructions in this manual will the full value of the warranty be honoured.

Some adjustments will need to be made periodically to properly maintain the Pressure Washer. All service and adjustments should be made at least one time each season. It is important that the maintenance chart below be followed.

ENGINE MAINTENANCE SCHEDULE

Frequency	Items	Each time	Every month or 20 Hrs	Every 3 month or 50 Hrs	Every 6 month or 100 Hrs	Every year or 300 Hrs
Engine oil	Check oil level	✓				
	Replace				✓	
Air cleaner (Filter)	Check	✓				
	Clean			✓	✓ *	
	Replace-clean					✓
Deposit cup	Clean				✓	
Spark plug	Clean,adjust				✓ ***	
	Replace					✓
Spark Arrester	Clean				✓	
Idling	Check-adjust					✓ **
Valve clearance	Check-adjust					✓ **
Fuel tank	Clean					✓ **
Fuel supply line	Check	Every two years (Replace if necessary**)				

- * Recommended to be performed more often than in the schedule if operated in dusty environments.
- ** Recommended to be performed by authorized dealers.
- *** Adjust air gap to 0.6mm-0.7mm.

CHECKING PRESSURE PUMP OIL:

1. Check oil site gauge on pressure pump. Oil should cover site gauge.
2. Remove dipstick/oil plug from crankcase and wipe clean.
3. Oil level is correct if it covers the lower half of the dipstick.

CHANGING PRESSURE PUMP OIL:

1. Place container under pressure pump oil drain plug.
2. Using a wrench, loosen oil drain plug.
3. Remove oil drain plug and drain oil into container.
4. Replace oil drain plug and retighten using the wrench.
5. Loosen and remove breather plug from the top of the pressure pump.
6. **Add NEW** SAE30 engine oil to pump case until the oil level raises above the midpoint on the oil level window on the side of the pump.
7. Replace and hand tighten the breather plug.

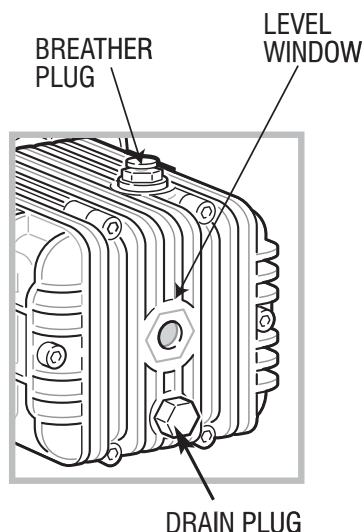

CLEANING NOZZLE:

Occasionally, the spray wand can become clogged with foreign materials such as dirt. When this happens, excessive pressure can develop. Whenever the pressure nozzle becomes partially clogged, the pump pressure will pulsate. It should be immediately cleaned.

1. Make sure Pressure Washer is shut off and spray gun trigger is locked.
2. Remove high pressure spray nozzle from the spray wand. Using the nozzle cleaning needle (provided), remove any obstructions by inserting and carefully moving the pin back-and-forth through the nozzle hole under clean running water.
3. After cleaning, remove the needle from the nozzle and store for future use.
4. Reassemble pressure nozzle to spray wand.

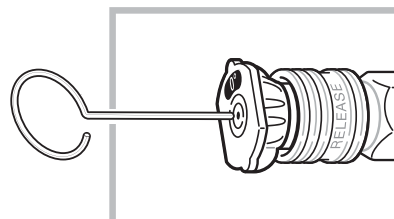

CLEANING WATER INLET SCREEN FILTER:

The water inlet screen filter should be checked periodically and cleaned if necessary.

1. Disconnect inlet water hose.
2. Remove filter by grasping the end and pulling straight back.
3. Clean screen filter by flushing both sides with water.
4. Insert screen filter back inside water inlet port.

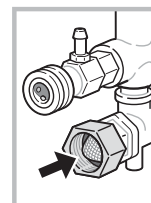

⚠ WARNING

Do not operate Pressure Washer without screen filter in place. Impurities entering pressure pump can cause internal damage.

CLEANING PRESSURE WASHER:

Daily or before use inspections should include areas around and underneath Pressure Washer looking for signs of fuel or oil leaks. Preventative maintenance should be taken if leaks are found. Clean accumulated debris from outside and inside Pressure Washer. Ensure all linkages, springs and other engine controls are kept clean. Inspect cooling air slots and openings on the Pressure Washer. Openings must be kept clean and unobstructed for peak performance of the Pressure Washer. Engine components should be kept clean reducing the risk of overheating and ignition of accumulated debris.

- Use a damp cloth to wipe exterior surfaces clean.
- Use a soft bristle brush to loosen caked-on dirt or oil.
- Use a shop-vacuum to pick up any loose dirt and debris.

STORAGE

⚠ WARNING



Fuel and fuel vapor are extremely flammable and explosive. Fire or explosion from misuse of fuel can cause severe burns and even death.

ENGINE

Gasoline fuel can become stale when stored over 30 days. Stale fuel causes acid and gum deposits to form in the fuel system or crucial carburetor parts. To keep fuel fresh, use Fuelset on the fuel tank (read instructions in the back for directions).

Draining gasoline is unnecessary if the Fuelset is used according to the instructions that come with it. Run Pressure Washer engine for a minimum of two minutes, after Fuelset is added to fuel, to allow it to circulate throughout the engine. The engine and fuel can be stored up to 24 months.

⚠ NOTE

DO NOT store gasoline from one season to another unless it's been treated with fuelset. Replace fuel container, if metal, and if it begins to rust. Rust, dirt and debris can contaminate fuel supply and components resulting in poor performance and/or internal damage to engine. Fuel should be stored in newer approved plastic storage containers.

TO PROTECT AGAINST RUST FORMATION DURING STORAGE, OIL THE CYLINDER BORE:

- Remove spark plug and pour approximately 1/2 oz (15 ml) of clean engine oil into the cylinder.
- Install spark plug and pull starter cord slowly to distribute the oil.
- Make sure engine **ON/OFF** switch is **OFF**. Slowly pull the starter cord 2 to 3 times to distribute and coat the cylinder bore with oil. **DO NOT** start the engine at this time.

⚠ WARNING



Unintentional sparking can cause a fire or electrical shock. Failure to observe this warning can cause severe property damage, severe burns and even death.

Disconnect spark plug wire from the spark plug and cover the tip of the spark plug wire with insulating tape and place wire where it cannot come into contact with the spark plug or Pressure Washer frame.

PRESSURE PUMP

1. Drain all water from the pressure hose, coil and store it in the cradle of the pressure washer handle.
2. Drain all water from the spray gun and spray wand by holding spray gun in a vertical position with the nozzle pointed downward. Squeeze trigger to remove fluids from the spray gun and spray wand. Store in spray gun/hose holder
3. Store chemical hose, high pressure hose and spray wand so they are protected from damage, such as being run over. It is **RECOMMENDED** that you follow these steps to protect the internal seals of the Pressure Washer when storing the unit for more than 30 days and/or when freezing temperatures are expected.
1. Obtain a funnel, six ounces of RV antifreeze and approximately 36 inches of garden hose with a male hose connector on one end.

⚠ CAUTION

Use only RV antifreeze. Any other type of antifreeze is corrosive and can damage pressure pump.

2. Connect 36 inch length of garden hose to water inlet of pressure pump.
3. Add RV antifreeze using the funnel.
4. Make sure engine **ON/OFF** switch is OFF. Slowly pull engine starter cord several times until antifreeze comes out of pressure hose connection of the pressure pump. **DO NOT** start the engine at this time.
5. Remove hose from water inlet of pressure pump.

PRESSURE WASHER

1. Cover Pressure Washer with a suitable cover that does not retain moisture such as a plastic or plastic coated tarp.
2. Store Pressure Washer in a clean, dry area.

⚠ WARNING



Certain storage covers can be flammable or can melt in higher temperatures. Do not place storage cover over Pressure Washer unit it has completely cooled.

PREPARING FOR USE AFTER STORAGE

1. Slowly pull the Starter cord a few times to clean oil from the cylinder or to eject any antifreeze from the pump which was added prior to storage.
2. Remove the spark plug from the cylinder. Wipe oil from the spark plug and return it to the cylinder and retighten.
3. Reconnect the spark plug wire.

TROUBLESHOOTING GUIDE

Problem	Probable Cause	Solution
Engine shuts down when running.	<ol style="list-style-type: none"> 1.Out of fuel. 2.Low Engine Oil 	<ol style="list-style-type: none"> 1.Fill fuel tank. 2.Add oil.
Engine will not start; or starts and runs rough.	<ol style="list-style-type: none"> 1.Engine On/Off set to "OFF" position. 2.Fuel valve is in "OFF" position. 3.Dirty air cleaner. 4.Out of fuel. 5.Stale fuel. 6.Spark plug wire not connected to spark plug. 7.Bad spark plug. 8.Water in fuel. 9.Flooded. 10.Excessively rich fuel/air mixture. 11.Intake valve stuck open or closed. 12.Engine has lost compression. 13.Low engine oil. 14.Wrong Fuel. 15.Engine is too hot. 16.Choke is in wrong position. 17.Pressure builds up after 2 pulls on starter coil or after initial use. 	<ol style="list-style-type: none"> 1.Set switch "ON" position. 2.Turn fuel valve to "ON" position. 3.Clean or replace air cleaner. 4.Fill fuel tank. 5.Drain fuel tank and carburetor; fill with fresh fuel. 6.Connect wire to spark plug. 7.Replace spark plug. 8.Drain fuel tank and carburetor; fill with fresh fuel. 9.Wait 5 minutes and re crank engine. 10.Call 0800 387 678 11.Call 0800 387 678 12.Call 0800 387 678 13.Add oil. 14.Use recommended fuel. 15.Allow engine to cool. 16.Change choke position. 17.Squeeze gun trigger to relieve pressure.

Problem	Probable Cause	Solution
Engine “hunts” or falters.	1.Carburetor is running too rich or too lean.	1.Call 0800 387 678
Engine lacks power.	1.Cylinder pressure is low. 2.Dirty air cleaner.	1.Call 0800 387 678 2.Replace air filter.
No pressure or low pressure.	1.Spray wand not set to high pressure. 2.Inadequate water supply. 3.Hose fitting leaks during high pressure. 4.Nozzle obstructed. 5.Water filter screen obstructed. 6.Defective pump. 7.Air in hose. 8.Choke lever in choke position. 9.Throttle control lever is not in fast position.	1.See“SELECTING THE RIGHT NOZZLE” section. 2.Water supply must be 5 GPM @20 psi. 3.Tighten hose fitting. Use thread sealant tape if necessary. 4.Clean Nozzle (See Maintenance). 5.Remove and clean filter. 6.Call 0800 387 678 7.Squeeze trigger to remove air. 8.Move choke to “RUN” position. 9.Move throttle control lever to fast position.
Water leaking at pump	1.Loose connections. 2.Piston packings worn. 3.Worn or broken O-rings. 4.Pump head or tubes damaged from freezing.	1.Tighten connections. 2.Clean or replace. Call 0800 387 678 3.Clean or replace. Call 0800 387 678 4.Clean or replace. Call 0800 387 678

Problem	Probable Cause	Solution
Pump will not draw chemicals	<ol style="list-style-type: none"> 1.Spray wand not set to low pressure. 2.Chemical hose/filter clogged. 3.Chemical screen not in chemical. 4.Chemical solution too thick. 5.Chemical build up in chemical injector. 	<ol style="list-style-type: none"> 1.See“SELECTING THE RIGHT NOZZLE” section. 2.Clean hose/filter. 3.Ensure end of chemical hose is fully submerged into chemicals. 4.Dilute chemical. Chemical solutions should have same consistency as water.
No or low pressure (after period of normal use).	<ol style="list-style-type: none"> 1.Worn seal or packing. 2.Worn or obstructed valves. 3.Worn unloader piston. 	Clean or replace. Call 0800 387 678
Water leaking at spray gun/spray wand connection.	<ol style="list-style-type: none"> 1.Worn or broken O-ring. 2.Loose hose connection. 	<ol style="list-style-type: none"> 1.Clean or replace O-ring. Call 0800 387 678 2.Tighten hose connection
Oil leaking at pump	<ol style="list-style-type: none"> 1.Oil seal worn. 2.Loose drain plug O-ring. 3.Worn drain plug O-ring. 4.Worn fill plug O-ring. 5.Pump overfilled. 6.Incorrect oil used. 7.Vent plug clogged. 	<ol style="list-style-type: none"> 1.Clean or replace. Call 0800 387 678 2.Tighten drain plug. 3.Inspect & replace O-ring. 4.Inspect & replace O-ring. 5.Check for correct amount. 6.Drain and refill with correct type and amount of oil. 7.Clean vent plug. Use air hose to free it of blockage. If problem persists, replace vent plug.
Pump pulsates	<ol style="list-style-type: none"> 1.Nozzle obstructed. 2.Air in the system. 	<ol style="list-style-type: none"> 1.Clean Nozzle (See Maintenance). 2.Squeeze trigger to remove air.

GENERAL INFO:

Gas	<ul style="list-style-type: none">• Use fresh high quality unleaded gasoline (minimum 87 octane).• Add stabilizer to fuel tank and run engine for 5 minutes before storage.
Oil	<ul style="list-style-type: none">• Pump oil: Use only SAE30 non-detergent oil.• Engine oil: Use only SAE30 non-detergent oil.• Use only cold water.
Water	
Pressure Adjustment	<ul style="list-style-type: none">• Do not operate pressure washer with clogged or missing water filter screen.• Do not operate pressure washer without adequate water supply to pressure pump. Adequate water supply is a minimum of 20 PSI @ 19 LPM
Pump	<ul style="list-style-type: none">• Pressure setting is preset at factory.• For lowering pressure, refer operation section of this manual.
By-Pass Mode	
*Optional Spare Parts	<ul style="list-style-type: none">• Squeeze spray gun trigger every 2 minutes while engine is running.• Do not allow water to freeze in pump.• Never leave unit running for more than 2 minutes without squeezing spray gun trigger. Doing so could damage pump and void warranty.
Hose	<ul style="list-style-type: none">• Pump is equipped with a thermal relief valve. If water overheats, this valve opens releasing gush of water. Afterwards, the valve closes returning pump to normal operation.
Engine	<ul style="list-style-type: none">• Do not allow hoses to come in contact with engine muffler during or immediately after use.• DO NOT pull unit by pressure hose.
Soap/Chemicals	<ul style="list-style-type: none">• Do not adjust or attempt maintenance without consulting supplied engine manual or having adjustments made at an authorized service center.• Add stabilizer to fuel tank and let engine run for 5 minutes before storage.• Always turn on water before starting engine.
Nozzle	<ul style="list-style-type: none">• Use only soaps and chemical detergents designed for pressure washer use.• Use Chemical nozzle(Black) with Soap/Chemicals.
Storage	<ul style="list-style-type: none">• Always keep nozzles unclogged.• Chemical/soap solutions cannot be applied using high pressure setting. Set pressure and use low pressure nozzle.
	<ul style="list-style-type: none">• Run clean water through chemical inlet.• Add stabilizer to any remaining fuel in fuel tank.• Do not allow water to freeze in pressure pump, spray gun, spray wand or hoses.

SPECIFICATIONS

Model	PS4400
Max. Pressure	4400PSI / 300bar
Flow Rate	15.1L/min
Displacement	459cc
Engine	Powerdyne 16HP Recoil Start
Pump	AR Triplex Pump with Brass Pump Head
Max Water Temp.	50°C
Fuel Tank Size	5.5L
Sound Pressure Level	114dB
Net Weight	80kg
Gross Weight	91kg
Detergent	Siphon Tube Detergent System
Machine Dimensions (LxWxH)	898 x 788 x 930mm

Warranty

As part of an on-going commitment to excellence in product support, Euroquip offers a comprehensive product warranty program.

1. THIS WARRANTY:

The benefits provided to the consumer in this warranty are in addition to other rights and remedies of a consumer under the New Zealand Consumer Guarantees Act 1993 and any other laws in relation to the products to which this warranty relates. This warranty:

- Covers the product against faulty materials or workmanship; and
- Covers the replacement of parts, the repair labour used, a refund of the price of the product or replacement of the machine, or other compensation for the remainder of the warranty period.

This product warranty is only applicable to the original purchaser of the machine and only purchases made from Euroquip Authorized Retailers.

2) WARRANTY PERIODS:

Commercial: 24 Months

Or

1000 hours of operation – whichever occurs first.

Commercial Warranty applies to commercial or business use of the product: All uses other than domestic use, including use for income-producing (including farming) or rental purposes.

*These Powershot Warranty periods are for products that are:

- Serviced by a Powershot Dealer in accordance with the Powershot service schedule, using genuine parts and the correct grade of oil (proof required)
- Meeting all other warranty requirements

NOTE: These warranty conditions apply to New Zealand only.

Euroquip warrants each new Powershot machine free from defect in material and workmanship under normal use and routine servicing, for the warranty periods specified. Conditional to the limitations and exclusions list below. The warranty period begins when the product is purchased by the end user. Warranty is not transferrable and is only claimable by the original purchaser.

Proof of purchase documentation with product serial number must be provided. If it has been lost and Euroquip does not have a record of the purchaser's details, the warranty period shall be calculated from the appropriate dealer wholesale sale date.

The purchaser must keep a record of all service and maintenance history as proof of servicing history. This may be requested when assessing any future warranty claims. The decision that an issue with a product qualifies as a warranty claim is made at the sole jurisdiction of Euroquip.

No costs incurred will be considered under warranty if repairs or maintenance are carried out by any party other than a Euroquip Approved Service Agent, unless with prior consent in writing from Euroquip.

It is the full responsibility of the purchaser to deliver the product under warranty to the nearest relevant service agent or product reseller. Warranty does not cover transportation costs including call outs, mileage and freight costs.

Customers are responsible for the care and cleaning of their product prior to sending it to our service centre. Any product being sent us must be thoroughly cleaned. Depending on what the product has come into contact with, it could pose an Occupational/ Work Health and Safety risk for our staff and or/service agents to inspect, repair or service a product that has come into contact with a hazardous substance. If we are asked to inspect, repair or service a product that has come into contact with a hazardous substance such as chemicals, asbestos or silica dust, we may not be able to inspect, service or repair the product. If this is the case, we will inform the purchaser and the product will be returned.

If a product is repaired under warranty, parts and labour required for the repair will be supplied at no charge. All defective parts replaced under warranty become property of Euroquip. Consumable items such as, but not limited to, oils, coolants, filter and spark plugs shall be the responsibility of the owner. Warranty assessment and repair will be scheduled and executed according to the normal work flow at the service location and depending on the availability of suitable replacement parts.

This warranty policy is an additional benefit and does not supersede the legal rights of any customer, reseller or service agent.

Should any issue be found to be a combination of a warranty failure and a non-warranty issue such as incorrect charging techniques, the repair cost component to rectify and repair the non-warranty failure is the **customer's** full responsibility.

3) EXCLUSIONS:

- Warranty does not cover parts that are subject to wear and tear from usage and/or damage which results from neglect of periodic maintenance.
- Evidence must be provided that the product has been maintained and serviced suitably for a claim to be considered under warranty.
- Batteries supplied with your product are warranted against defect for 3 months and does not include lack of charge due to non-use. Consumable items such as, but not limited to, oils, coolants, filters, spark plugs and batteries shall be the responsibility of the purchaser.
- Failure caused by incorrect operation of the product as specified in the manual either intentionally or by error.
- Lack of proper care and maintenance of the product.
- Any damage which results from unavoidable natural disasters, fire, collision, theft, etc.
- Any normal wear or deterioration, such as that of sliding or rotating parts caused under normal operating conditions.
- Any damage that results from misuse or use beyond the imitations of the products intended purpose (such as overloading or use under abnormal conditions).
- External circumstances such as product deterioration or corrosion due to environmental conditions like heat, cold, salt spray, sand or due to the passage of time
- Normal phenomena such as noise, vibration or oil seepage which are considered by Euroquip as not affecting the quality, function or performance of the product.
- Any damage due to improper storage or transport.
- Consumable replacement items: Spark plugs, contact points, shear pins, fuel strainers, oil filter elements, air cleaner elements, brake shoes or pads, clutch components, fuses, motor brushes, gaskets, tube or hoses, belts, cutting blades, light bulbs, serviceable bearings. Petroleum and others fluids: Oil, grease, battery electrolyte, and radiator coolant. Other items specified by Euroquip.
- Periodical maintenance items such as cleaning, inspection and adjustments.
- Contaminated fuel
- Modifications or installations of other products to the product
- Damage that results from the use of non-genuine parts, lubricant or fluid not approved by Euroquip
- Any repair and/or adjustment to correct improper or poor quality work previously performed.
- Attempted repair/ service by a party other than an Approved Service Agent, or any repair undertaken prior to approval of warranty by Euroquip is not covered under warranty.
- Warranty does not cover pre delivery service and adjustment, or failure that may occur as a result of lack of/ incorrect pre delivery service and adjustment. Warranty does not cover any incidental, indirect or consequential loss, damage, personal injury, or expense that may result from any defect, failure, malfunction, or misuse of a product.
- Any product that is found to have come into contact with hazardous substances such as chemicals, asbestos or silica dust and NOT been industrially cleaned prior to servicing.

4) HOW TO CLAIM WARRANTY:

In the event you are faced with a manufacturing fault with your Powershot product, you can claim a repair or part replacement under warranty if the following conditions are fulfilled:

- The problem is related to production quality or specifications of the machine
- The machine is within the warranty period outlined in schedule
- The issue does not fall within the warranty exclusions listed

If the criteria above is met, and you would like to request a warranty, then please go online to <https://www.euroquip.co.nz/Service-Request-End-User> and log your warranty claim.



Congratulations on your new **POWERSHOT** product. We are proud to have you as our customer and will strive to provide you with the best service and reliability in the industry. This product is backed by our extensive warranty and service network. Please contact your local agent or submit a service case online for fast response at **customerservice@euroquip.co.nz**